

# **X** **EURO-MIX®**

**Top adhesives and plasters**

MANUFACTURER OF BUILDING CHEMICALS



## **PRODUCT INFORMATION**

## EXTERNAL WALL INSULATION SYSTEM

### BASIC SYSTEM INFORMATION

The "EURO-MIX" system is a system for insulating external walls of buildings using the light-wet method, in which the insulating layer consists of polystyrene boards and the facade layer consists of thin-layer plaster on an adhesive mortar reinforced with fiberglass mesh. **The "EURO-MIX" system** includes the following elements:

- mortar for gluing EX 2.02 START polystyrene boards,
- adhesive mortar for polystyrene and **EX 2.02 mesh** (universal),
- EPS-EN 13163 polystyrene boards,
- expansion plugs with a plastic pin, 4 pcs./m<sup>2</sup>,
- fiberglass mesh,
- primer for plaster **EX 7.01**,
- noble mineral plaster **EX 3.02** of the "textured plaster" type or any type of plaster (mineral, acrylic, silicate, etc.).

Additionally, the work process involves the use of skirting boards, aluminum corners with fiberglass mesh, window strips, and connectors.

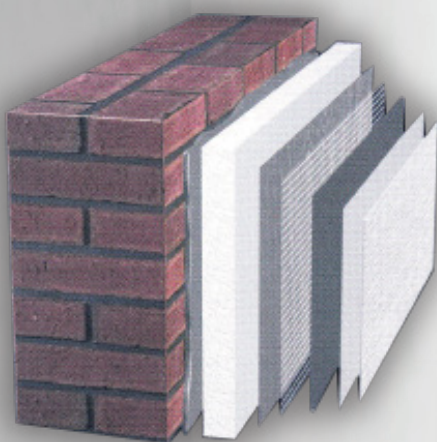

### STAGES OF WALL INSULATION IN THE "EURO-MIX" SYSTEM

- 1) **SUBSTRATE PREPARATION** (levelling, dust removal, degreasing, removal of loose elements, filling of significant defects in the façade, priming if necessary)
- 2) **EXECUTING THE THERMAL INSULATION LAYER FROM POLYSTYREFOAM BOARDS** (it involves gluing the boards to the substrate using EX 2.02 START glue or EX 2.02 universal glue, applied around the perimeter with 5-8 cm breaks and in the form of patches in the middle of the board)
- 3) **PINNING POLYSTYROFOAM BOARDS** (this operation is necessary above a height of 6 m and in case of questionable condition of the substrate)
- 4) **EXECUTING A LAYER REINFORCEED WITH FIBERGLASS MESH** (the mesh is embedded in EX 2.02 Styrofoam glue applied with a notched trowel to the even surface of the boards **after previously strengthening the corners of window and door openings with an additional layer of mesh placed at an angle of 45° to the opening line; after the adhesive has set, another layer of it should be additionally applied to obtain the most even surface for thin-layer plaster**)
- 5) **PRIMING THE REINFORCED LAYER** (this operation aims to increase and improve the contact surface of the thin-layer plaster with the substrate - better adhesion is achieved and the water absorption of the substrate is reduced)
- 6) **APPLICATION OF PLASTER ADVANTAGES OF THE SYSTEM ON STYROFOAM:**
  - lower cost of facade insulation compared to a wool system, thanks to lower material consumption (glue, pins),
  - easy mechanical processing of polystyrene boards,
  - light thermal insulation material (less loaded façade),
  - any choice of plaster type (mineral, acrylic, silicate, etc.),
  - better thermal insulation compared to mineral wool with the same board thickness.



## TRADE NAME: EX 1.01

**PRODUCT:** Adhesive mortar for ceramic tiles and terracotta (indoor use). **C1T-adhesive is cement-based (C), regular (1), with reduced sagging (T)**

### APPLICATION:

- for gluing ceramic tiles and shapes, terracotta indoors on floors and walls (plastered, concrete, made of ceramic materials),
- can also be used as putty or strong masonry, leveling mortar (up to 5 mm),
- for gluing tiles with max. block length **40 x 40 cm**,
- should not be used for large format boards.

**PACKAGING:** 5 kg, 25 kg

**CONSUMPTION:** 2 to 3,5 kg/m<sup>2</sup>



## TRADE NAME: EX 1.02 plus

**PRODUCT:** Adhesive mortar for ceramic and stone tiles, elasticized. **C2T-cement glue (C), with enhanced parameters (2) and reduced sagging (T)**

### APPLICATION:

- water- and frost-resistant,
- inside and outside the building on walls, plinths, floors (also with underfloor heating),
- for gluing tiles with max. block length **60 x 60 cm**,
- for mounting clinker tiles on the facade.

**PACKAGING:** 5 kg, 25 kg

**CONSUMPTION:** 2,3 to 3,1 kg/m<sup>2</sup>



## TRADE NAME: EX 1.03 super

**PRODUCT:** Highly flexible adhesive for ceramic and stoneware tiles with fibers. **C2TES1 - cement adhesive (C), with improved parameters (2), with reduced sagging (T), with extended open time (E), flexible (S1).**

### APPLICATION:

- water and frost resistant, highly flexible, deformable,
- very good adhesion and very high strength and deformability,
- gluing ceramic tiles and shapes, stoneware tiles, terracotta, mosaics, clinker,
- in places especially exposed to frost and water: terraces, balconies, window sills, external stairs, swimming pools,
- on OSB boards after priming with **EX 7.04 OSB&BETON** Primer,
- for gluing tiles to tiles,
- in underfloor heating systems.

**PACKAGING:** 5 kg, 25 kg

**CONSUMPTION:** 3 to 5 kg/m<sup>2</sup>



## TRADE NAME: EX 1.03 M

**PRODUCT:** Highly elastic white adhesive for marble and natural stones as well as tiles made of absorbent materials. **C2TES1-cement adhesive (C), with enhanced parameters (2), with reduced sagging (T), with extended open time (E), flexible (S1).**

### APPLICATION:

- water and frost resistant, highly flexible, deformable,
- for gluing elements made of marble and other natural stones,
- in places sensitive to discoloration after using traditional adhesive mortars based on gray cement,
- in underfloor heating systems, for terraces, balconies, window sills, external stairs, swimming pools, fireplace linings,
- gluing tiles to tiles.

**PACKAGING:** 5 kg, 25 kg

**CONSUMPTION:** 3 to 5 kg/m<sup>2</sup>



## NEW! TRADE NAME: EX 1.06 B GEK

**PRODUCT:** Adhesive mortar based on white cement for bonding absorbent and non-absorbent large-format ceramic tiles (max. 100 x 150 cm) and natural stones sensitive to discoloration, etc. **C2TS1-cement adhesive (C), with enhanced parameters (2) with reduced sagging (T), flexible (S1).**

**APPLICATION:** For use on horizontal and vertical surfaces, inside and outside the building, in places requiring a flexible, high-strength adhesive and very good adhesion in general construction, residential and industrial construction, in wet rooms such as kitchens, bathrooms, garages, in service and commercial facilities, offices, public facilities. **Important!** When gluing large-format tiles, stoneware or natural stone, the bottom of the tiles should be additionally filled with glue to ensure full coverage.

### Advantages:

- water and frost-resistant,
- much better application than standard mortars thanks to the gel consistency,
- easy to achieve full mortar flow,
- adhesive layer thickness 2-15 mm,
- for many types of tiles - stoneware, clinker, natural stone,
- no shrinkage effect of the glue during its setting,
- does not cause discoloration of natural stone tiles.



## Type of substrate:

- all standard mineral building substrates - cement, gypsum,
- plasterboards, gypsum substrates, waterproofing layers,
- OSB boards using **EX 7.04 OSB & CONCRETE PRIMER**,
- tile on tile using **EX 7.04 OSB & CONCRETE PRIMER**,
- top layer for tile cladding in underfloor heating systems,
- cement-lime plasters and cement screeds after stabilization (approx. 28 days),
- concrete 3 months after pouring,
- highly absorbent substrates (such as aerated concrete, aerated concrete, gypsum) after priming with **PORO-GRUNT EX 7.02**.

**PACKAGING:** 23 kg

**CONSUMPTION:** 3,2 to 3,6 kg/m<sup>2</sup>



**TRADE NAME:** **EX 2.01**

**PRODUCT:** Adhesive mortar for mineral wool

### APPLICATION:

- for gluing façade panels made of mineral wool (also made of polystyrene) and for embedding fiberglass mesh,
- the mortar is water and frost-resistant,
- very good durability and increased adhesion to all plastered and unfinished mineral wall surfaces (brick, ceramic block, cinder block, aerated concrete blocks, prefabricated elements, etc.),
- for gluing on OSB boards primed with **EX 7.04 OSB&BETON GRUNT**,
- the mortar cannot be used on wooden, metal or plastic surfaces (such as siding).

**PACKAGING:** 25 kg

**CONSUMPTION:** 5 to 6 kg/m<sup>2</sup> when gluing boards to walls, approx. 5 kg/m<sup>2</sup> when gluing fiberglass mesh



**TRADE NAME:** **EX 2.02 START**

**PRODUCT:** Mortar for gluing polystyrene boards

### APPLICATION:

- for gluing polystyrene boards to all types of clean construction substrates except wood, sheet metal and plastics,
- high resistance to shear forces, high adhesion to the substrate,
- water- and frost-resistant,
- it should not be used to make a layer reinforced with mesh in building insulation systems!

**PACKAGING:** 25 kg

**CONSUMPTION:** 4,5 kg/m<sup>2</sup>



**TRADE NAME:** **EX 2.02**

**PRODUCT:** Adhesive mortar for mesh and polystyrene with cellulose fibers.

### APPLICATION:

- fastening of white polystyrene boards with the addition of graphite or graphite boards that meet the parameters of the PN-EN 13163:2013 standard, in terms of reaction to fire class at least E and min. DS(N)2-BS75-DS.(70,-) 2-TR100,
- making a layer reinforced with fiberglass mesh for plasters when insulating external walls buildings using the light-wet method in the **"EURO-MIX" system**,
- high strength and very good adhesion to most plastered and unfinished mineral wall substrates (brick, ceramic block, cinder block, aerated concrete blocks, prefabricated elements, etc.),
- Completely water- and frost-proof,
- for gluing on OSB boards primed with **EX 7.04 OSB&BETON GRUNT primer**,
- The mortar cannot be used on wooden, metal or plastic surfaces (e.g. siding). Also available in the EX 2.02B version on white cement.

**PACKAGING:** 25 kg

**CONSUMPTION:** approx. 4.5 kg/m<sup>2</sup> when gluing polystyrene, approx. 3.4 kg/m<sup>2</sup> when gluing fiberglass mesh



**TRADE NAME:** **EX 4.02**

**PRODUCT:** One-component sealing mortar

### APPLICATION:

- cement waterproofing under ceramic tile cladding,
- for internal/external use,
- dry cement mortar for applying waterproofing coatings inside and outside buildings, on horizontal and vertical elements, in places particularly exposed to water, such as floors, internal walls, foundations in residential and farm buildings.

**PACKAGING:** 15 kg and 4 kg (on request)

**CONSUMPTION:** 2.7 kg of dry matter per 1 m<sup>2</sup> with a layer of 2-3 mm (on absorbent and porous substrates)



TRADE NAME: **EX 3.02**

**PRODUCT:** White mineral plaster

**APPLICATION:**

- EX 3.02 white mineral plaster available with a textured plaster structure with grain diameters of 1, 1.5, 2 and 2.5 mm.
- intended for thin-layer plastering outside or inside buildings on typical, even and smooth mineral wall substrates,
- hydrophobized, vapor permeable,
- is a component of a set of products for insulating external walls of buildings,
- can also be used to cover old traditional plasters,
- possibility of painting with facade paints.

**PACKAGING:** 25 kg

**CONSUMPTION:** textured plaster 1 mm – 2.5 kg/m<sup>2</sup>  
textured plaster 1.5 mm – 2.8 kg/m<sup>2</sup>  
textured plaster 2 mm – 3.0 kg/m<sup>2</sup>  
textured plaster 2.5 mm – 3.5 kg/m<sup>2</sup>

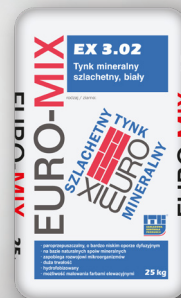

textured plaster  
1 mm – 2.5 kg/m<sup>2</sup>



textured plaster  
1.5 mm – 2.8 kg/m<sup>2</sup>



textured plaster  
2 mm – 3.0 kg/m<sup>2</sup>



textured plaster  
2.5 mm – 3.5 kg/m<sup>2</sup>

TRADE NAME: **EX 5.05**

**PRODUCT:** CSIII internal/external machine plaster mortar, fine-grained, light

**APPLICATION:**

- light cement and lime mortar for making machine plasters in one or two layers,
- also for manual application,
- on the interior and exterior walls of residential or farm buildings made of hollow bricks, brick or concrete,
- after setting, it obtains an OLD WHITE color,
- efficient and easy to process,
- thanks to the content of perlite, it has thermal insulating properties.

**PACKAGING:** 25 kg

**CONSUMPTION:** approx. 17 kg of dry matter per  
1 m<sup>2</sup> at a thickness of 1 cm



TRADE NAME: **EX 6.01 / EX 6.01B**

**PRODUCT:** Cement putty, gray and white, water- and frost-proof.

**APPLICATION:**

- for leveling, repairing and renovating wall, floor and ceiling surfaces,
- inside and outside buildings,
- perfect for rooms with high humidity, such as bathroom, kitchen, laundry room,
- excellent adhesion to concrete (including cellular concrete), cement-lime plasters,
- for filling joints of ceiling slabs and other prefabricated elements,
- ideal substrate for dispersion paints, mineral and resin plasters, wallpapers,
- compared to gypsum putties, it is resistant to frost and water, much higher strength and has an alkaline reaction, which is important when using it as a painting base,
- thin layer application from 1 mm to 5 mm.

**PACKAGING:** 8 kg lub 25 kg

**CONSUMPTION:** 1.7 kg/m<sup>2</sup> at a thickness of 1 mm



TRADE NAME: **EX 9.01**

**PRODUCT:** Masonry and cement mortar, Class M15

**APPLICATION:**

- dry masonry mortar intended for building foundation walls, load-bearing pillars, walls, vaults and arches. For making floors and surfaces for external and internal plasters and for all types of anchoring elements. Mortar for use inside and outside the building; it is frost-resistant and waterproof.
- Used in building elements that are subject to fire reaction and thermal insulation requirements.

**PACKAGING:** 25 kg

**CONSUMPTION:** approx. 8 kg/m<sup>2</sup> with a joint  
thickness of 5 mm



## TRADE NAME: **EX 9.02 / EX 9.02B / EX 9.02B WINTER**

**PRODUCT:** Masonry mortar for thin joints available in **GRAY** color, class **M5** or **WHITE**, class **M5** and **M10**, as well as the **M10 WINTER** version, which makes it possible to use the mortar from -2 degrees C in the winter months (**November-April**).

**APPLICATION:**

- water- and frost-resistant mortar for thin-layer construction of walls made of aerated concrete blocks and silicates,
- for use inside and outside buildings,
- for filling small gaps and for putting with a layer thickness of up to 3 mm,
- efficient and easy to use with optimal correction time.

**PACKAGING:** 25 kg

**CONSUMPTION:** 8 kg/m<sup>2</sup> of aerated concrete block wall with dimensions. 25x25x50 cm with a joint thickness of 3 mm

## TRADE NAME: **EX 9.03**

**PRODUCT:** Plastering and masonry mortar class M10

**APPLICATION:**

- intended for external and internal plastering and mounting all types of anchoring elements.
- for building foundation walls, load-bearing pillars, walls, vaults and arches,
- frost and waterproof.

**PACKAGING:** 25 kg

**CONSUMPTION:** 1,45 kg/m<sup>2</sup> with a joint thickness of 1 mm

## TRADE NAME: **EX 9.04 S**

**PRODUCT:** Mortar for bricklaying and grouting clinker **with the addition of Trass** (M10 class and grain size up to 1 mm)

**APPLICATION:**

- for building and simultaneously grouting facing walls made of clinker bricks with low water absorption (<5%)
- after setting, the mortar becomes highly resistant to aggressive environmental influences,
- has low shrinkage during setting,
- it is flexible and vapor permeable,
- the addition of trass binds the "free" lime, which significantly reduces the risk of white efflorescence on the wall
- available in 5 colors: **gray, cream-white, anthracite, brown, sand, black**

**PACKAGING:** 25 kg

**CONSUMPTION:** while bricklaying and grouting:  
40 kg/m<sup>2</sup> of brick wall with dimensions 7x11, 5x24 with a joint thickness of 1 cm

## TRADE NAME: **EX 10.01**

**PRODUCT:** CT-C12-F3 leveling mortar (cement)

**APPLICATION:**

- for executing floor subfloors with a thickness of 0.5 mm to 4 cm and for filling gaps in typical mineral substrates (concrete, cement mortar, cement screed),
- inside and outside buildings,
- recommended for leveling the surface before laying tiles on adhesive mortar, carpets or wooden and wood-like coverings such as panels and parquet.

**PACKAGING:** 25 kg

**CONSUMPTION:** 1.6 kg/m<sup>2</sup> at a thickness of 1 mm, i.e.  
at a thickness of 5 mm - 9.6 kg/m<sup>2</sup>  
at a thickness of 4 cm - 2.5 bags per 1m<sup>2</sup>



TRADE NAME: **EX 10.02**

**PRODUCT:** Self-leveling cement screed 2-20 mm

**APPLICATION:**

- used for making floor subfloors in a layer of 2-20 mm inside buildings and for leveling various mineral substrates before laying cladding,
- perfect for use in rooms exposed to moisture,
- suitable for underfloor heating,
- Perfectly spreads and levels, creating a smooth surface,
- quick setting - 6 hours at 23°C, humidity 50%,
- before making the screed, the substrate should be primed with our **EX 7.03 FLOORGRUNT** primer.

**PACKAGING:** 25 kg

**CONSUMPTION:** approx. 3 kg/m<sup>2</sup>



TRADE NAME: **EX 10.03**

**PRODUCT:** Thick-layer cement screed 10-80 mm

**APPLICATION:**

- used for manual execution (the mass is removed along the strip) of thick-layer underlays for coverings made of ceramic and stone tiles, carpets, PVC, panels, etc.,
- suitable for underfloor heating,
- the substrate should be primed (except when we plan to apply a screed on foil) with **EX 7.03 FLOORGRUNT** or, in the case of non-absorbent substrates, **EX 7.04 BETON&OSB GRUNT**,
- the setting time of the screed is 6-8 hours. After 24 hours, cover with construction foil for 7 days.

**PACKAGING:** 25 kg

**CONSUMPTION:** approx. 25 kg (bag) per 1 m<sup>2</sup> at 10 mm thickness



TRADE NAME: **GX 01**

**PRODUCT:** Snow-white, flexible gypsum plaster

**APPLICATION:**

- for thin-layer puttying of wall surfaces and ceilings indoors,
- for filling gaps in plasters and for connecting and grouting plaster elements, including plasterboards,
- an ideal base for all types of paint coatings and wallpapers. Does not shrink during setting, easy to process after setting,
- **POSSIBILITY OF APPLICATION WITH AN AGGREGATE AND A ROLLER.**

**AGGREGATE APPLICATION:** In the tests for GX 01, a **GRACO T MAX 506** device was used; standard hoses; Gun - TMAX lance; nozzle-HDA 651; Filters-18 MESH; pressure: 50-52 Bar; 1 liter was added to the recommended amount of water per 20 kg of product.

**PACKAGING:** 5 kg, 20 kg

**CONSUMPTION:** 1,2 kg/m<sup>2</sup>



TRADE NAME: **GX-START**

**PRODUCT:** OLD WHITE plaster putty (inside)

**APPLICATION:**

- for manual thin-layer puttying of wall and ceiling surfaces,
- as filling holes and cracks in the substrate,
- for smoothing rough surfaces,
- as a starting and base layer for **GX 01** gypsum plaster,
- inside buildings on typical mineral substrates, i.e. concrete, cement, cement-lime, gypsum, aerated concrete, which are not exposed to direct moisture,
- plaster can be applied in several layers with a thickness of 1-8 mm,
- easy application to walls and ceilings,
- does not require priming before applying the final layer of GX 01 plaster,
- quick drying,
- color after drying - **OLD WHITE**
- easy grinding.

**PACKAGING:** 4,5 kg, 20 kg

**CONSUMPTION:** 1,3 kg/m<sup>2</sup> with a layer of 1 mm





## TRADE NAME: **GX-02**

**PRODUCT:** Polymer universal putty for walls, ceilings and plasterboards.

**APPLICATION:**

- indoors,
- for smoothing the surface of concrete walls and ceilings,
- for smoothing cement-lime and gypsum plasters,
- for finishing plasterboard plastering,
- **manual, roller and spray methods.**

**PACKAGING:** 2 kg, 10 kg, 27 kg

**CONSUMPTION:** 1,5 kg/m<sup>2</sup> with a layer thickness of 1 mm



## TRADE NAME: **EX 7.01 Primer for mineral and acrylic plasters**

**PRODUCT:** Liquid primer, white

**APPLICATION:**

- primer for mineral plasters EX 3.02 in the EURO-MIX system,
- primer for acrylic plasters,
- for priming ordinary plasters, concrete and gypsum substrates, chipboards and plasterboards,
- for priming dusty substrates under cement and cement-lime mortars, putties.

**PACKAGING:** 6,4 kg, 16 kg

**CONSUMPTION:** 0,35 kg/m<sup>2</sup>



## TRADE NAME: **EX 7.02 PORO GRUNT**

**PRODUCT:** Liquid primer, concentrate 1:1 (1 kg, 5 kg) and already diluted (10 kg)

**APPLICATION:**

- for priming all absorbent and porous substrates, such as: gypsum, anhydrite, concrete, cement, cement-lime, aerated concrete, gypsum boards,
- for indoor and outdoor use,
- increases the adhesion of adhesive mortars, paints, plasters,
- equalizes the absorbency of various substrates and thus strengthens and protects them against moisture,
- creates a contact layer that prevents the formation of swelling minerals at the substrate-mortar interface,
- compatible with leading paints on the market.

**PACKAGING:** 1 kg, 5 kg, lub 10 kg (in diluted form)

**CONSUMPTION:** 0,1 do 0,2 kg/m<sup>2</sup> may be higher (depending on the absorbency of the substrate)



## TRADE NAME: **EX 7.03 FLOORGRUNT**

**PRODUCT:** FLOORGRUNT is intended for reducing and leveling the absorbency of substrates.

**APPLICATION:**

- intended for reducing and leveling the absorbency of substrates,
- recommended for use under self-leveling and self-leveling floors,
- used on mineral substrates such as: concrete, cement-lime plaster, cement plaster, terrazzo.

**PACKAGING:** 1 kg, 5 kg, 10 kg

**CONSUMPTION:** 0,1 kg/m<sup>2</sup> do 0,4 kg/m<sup>2</sup> (depending on the absorbency of the substrate)



## TRADE NAME: **EX 7.04 Beton & OSB Grunt**

**PRODUCT:** CONCRETE & OSB The bonding primer is intended for priming tight and non-absorbent substrates.

**APPLICATION:**

- increases surface adhesion,
- for priming mineral substrates (such as concrete, cement-lime plaster, cement plaster, terrazzo),
- for priming substrates covered with a well-bonded plastic-based paint coating,
- for priming OSB boards,
- for priming plasterboards,
- for priming glassy surfaces (e.g. tiles),
- inside and outside buildings.

**PACKAGING:** 2,5 kg, 7 kg, 14 kg

**CONSUMPTION:** from 0.2 kg/m<sup>2</sup> to 0.4 kg/m<sup>2</sup>  
(depending on the absorbency of the substrate)



## TRADE NAME: **INVEST GRUNT EX 7.06**

**PRODUCT:** Liquid priming preparation

**APPLICATION:**

- for priming gypsum, plasterboard, cement, cement-lime and concrete substrates.
- Do not dilute!**

**PACKAGING:** 5 kg

**CONSUMPTION:** from 0.1 to 0.4 kg/m<sup>2</sup>  
(depending on the absorbency of the substrate)



## TRADE NAME: **GEL PRIMER EX 7.07**

**PRODUCT:** Gel priming preparation, non-dripping priming preparation for substrates with increased absorption before painting.

**APPLICATION:**

- for priming substrates: plaster, concrete, cement, cement-lime, plasterboard,
- for priming substrates finished with both polymer and classic plasters,
- for use inside buildings. **Do not dilute!**

**PACKAGING:** 5 kg

**CONSUMPTION:** approx. 0.15 kg/m<sup>2</sup> (depending on the absorbency of the substrate)



## TRADE NAME: **SILICONE EXTERIOR PAINT**

**PRODUCT:** Ready-to-use silicone resin-based paint containing very fine sand that roughens the painted surface.

**APPLICATION:**

- for painting new and renewable substrates,
- outside buildings using manual and spray methods.

**PACKAGING:** 3 L, 5 L, 10 L

**CONSUMPTION:** ok. 0,15 – 0,4 L/m<sup>2</sup>  
(depending on the absorbency of the substrate)



## TRADE NAME: **Tixo-Gel PAINTS**

**PRODUCT:** Acrylic paint containing pigments and anti-microbial agents

**APPLICATION:**

- for painting surfaces covered with plaster, gypsum drywall, concrete and cement surfaces,
- for manual and spray application

**PACKAGING:** 3 L, 5 L, 10 L

**CONSUMPTION:** 0,15 L/m<sup>2</sup>





## TRADE NAME: UNIMAL PREMIUM

**PRODUCT:** Matte latex paint containing pigments and antimicrobial agents

**APPLICATION:**

- painting walls inside and outside rooms made of cement, cement-lime plasters, concrete surfaces, gypsum plasters, plasterboards,
- surfaces painted with emulsion paints,
- provides a surface resistant to dirt and resistant to washing and scrubbing.

**PACKAGING:** 3 L, 5 L, 10 L

**CONSUMPTION:** 0,15 L/m<sup>2</sup>



## TRADE NAME: INVEST WHITE

**PRODUCT:** Invest White acrylic paint.

Ready-to-use paint based on acrylic resin and a combination of binders.

**APPLICATION:**

- for painting inside buildings by hand and spraying.

**PACKAGING:** 10 L

**CONSUMPTION:** ok. 0,15 L/m<sup>2</sup>  
(depending on the absorbency of the substrate)



## TRADE NAME: GRANITI MOSAIC PLASTER

**PRODUCT:** Plastering mass containing copolymers, natural marble aggregate, quartz grit and additives that protect against microorganisms.

**APPLICATION:**

- intended for decorative coatings,
- inside and outside residential and public buildings, including health care and educational facilities,
- the dried surface has a vapor-permeable layer,
- the mass can be applied to any surface, except wooden, metal, glass and plastic surfaces, and in places not exposed to constant and continuous contact with standing water,
- **do not mix vigorously with a mixer before applying,**
- the full color palette is available from EURO-MIX sales representatives or on the website [www.euromix.com.pl](http://www.euromix.com.pl)

**PACKAGING:** 15 kg

**CONSUMPTION:** approx. 3.0 kg/m<sup>2</sup>  
(depending on the absorbency of the substrate)



## TRADE NAME: SILICONE PLASTER

**PRODUCT:** Ready-made plaster mass intended for applying thin-layer, decorative plasters on new and renovated surfaces, both inside and outside buildings.

**PACKAGING:** 20 kg

**CONSUMPTION:** 1,5 mm - 2,0-2,5 kg/m<sup>2</sup>

## TRADE NAME: SEALING TAPE

**PRODUCT:** Waterproof, flexible sealing tape for sealing expansion joints and creating elastic sealing of floor and wall joints. Waterproof, flexible sealing tape for sealing expansion joints and creating a flexible seal for floor and wall joints. Our offer also **includes internal and external corners.**

**APPLICATION:**

- as a sealing element for expansion joints, corners of walls and floors, edges of building structures,
- used in places of increased stress and in places particularly exposed to moisture, such as: terraces, foundation walls, underground and ground concrete structures, balconies, swimming pools, toilets, bathrooms, kitchens, car washes, flat roofs,
- remember that the surfaces on which the tape is mounted are even, stable and strong and free from dust, grease and other contamination,
- in case of doubts as to the quality of the substrate to which the tape is to be installed, a test should be performed,
- install the tape using **EuroHydroFol** sealing compound.

**PACKAGING:** 50 meters





TRADE NAME: **EuroHydroFol**

**PRODUCT:** One-component, flexible sealing compound containing copolymers, fillers, pigments and agents protecting against microorganisms. It is characterized by very good grip and elasticity. Creates waterproof coatings, does not contain solvents (ecological product).

**APPLICATION:**

- it is mainly used to seal walls and floors in rooms exposed to water, such as bathrooms, kitchens, swimming pools, and outdoors on terraces and balconies,
- can be used as a covering foil on surfaces exposed to micro-cracks below 1 mm.

**PACKAGING:** 1,1 kg, 5 kg, 10 kg

**CONSUMPTION:** depending on the substrate  
1.2 to 1.6 kg/m<sup>2</sup> with a layer thickness of 1 mm.

TRADE NAME: **IMPREGNOSIL**

**PRODUCT:** Silicone impregnation for paving stones, concrete elements, bricks and gypsum-cement tiles.

**APPLICATION:**

- for maintaining and protecting paving stones, concrete elements (concrete fences, decorative concrete accessories, bricks, gypsum tiles and cement-gypsum tiles),
- the agent enhances the color,
- perfectly protects against water, oils, rubber from car tires, facilitates the removal of oil stains,
- prevents the growth of mosses and lichens,
- increases the frost and water resistance of cubes, concrete accessories, cement-gypsum and gypsum tiles.

**PACKAGING:** 1 kg, 5 kg

**CONSUMPTION:** 4-7 m<sup>2</sup>/kg (depending on the absorbency of the substrate and method of application)

TRADE NAME: **CLEARNITI**

**PRODUCT:** Agent for cleaning dirt on the facade, on the surface of ceramic tiles, mosaic plasters, pigment plasters, mineral plasters, refreshing joints and for cleaning clinker from lime efflorescence.

**APPLICATION:**

- intended for removing even the oldest residues, dirt and coatings from various types of cement and lime building mortars,
- for cleaning dirty facades with mosaic plaster (GRANITI type), facades with mineral plaster and pigment plaster,
- for cleaning various types of ceramic tiles dirty with dried residues of grout, adhesives and cement mortars,
- to remove dirt, sediment and stains caused by minerals contained in water and rust deposits, etc.,
- for cleaning and refreshing old grout joints and clinker from lime efflorescence.

**PACKAGING:** 1 kg, 5 kg

**CONSUMPTION:** depends on the porosity and absorbency of the substrate and the degree of its contamination and amounts to approx. 0.15 kg/m<sup>2</sup>

TRADE NAME: **Veli Gel**

**PRODUCT:** Colorless acrylic paint for interior and exterior use

**APPLICATION:**

- for painting surfaces covered with plaster, paint, mosaic plaster, putty, replaces paneling.
- after drying, it gives a completely washable surface.
- ideally suited for places particularly exposed to dirt, communication routes, residential premises, offices, restaurants, hotels, cafes, hospitals, salons, wherever we want to easily maintain cleanliness in accordance with the requirements of the Sanitary and Epidemiological Station.
- also available in shades of gold, silver, pink, blue and green. A wall painted with colored velle gel gives reflections in the above-mentioned colors.
- for manual and spray application.

**PACKAGING:** 0,7 kg, 4 kg

**CONSUMPTION:** 0,15 kg/m<sup>2</sup>



PRODUCTION, TRADING AND SERVICE ENTERPRISE



44-240 Żory, ul. Boczna 6

Tel.:

Sales department

+48 32 / 73 40 531

Technical advice

+48 32 / 43 44 472

Wholesaler

+48 32 / 73 40 496-7

Secretary's office/fax

+48 32 / 43 44 472



email:

[biuro@euromix.com.pl](mailto:biuro@euromix.com.pl)

[sprzedaz@euromix.com.pl](mailto:sprzedaz@euromix.com.pl)

internet:

[www.euromix.com.pl](http://www.euromix.com.pl)

[www.facebook.com/euromixpl](https://www.facebook.com/euromixpl)

